

These pumps used advanced technology with high efficiency and minimized noise. The pumps are designed and manufactured according to all the requirements by CSA. Pump casing is made of reinforced plastic. The strainer includes a big filter basket, a see-thru cover for quick inspect of the strainer.

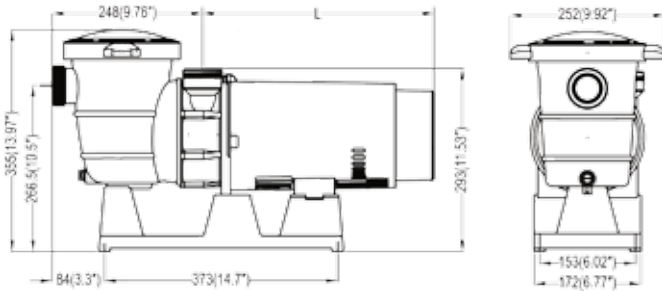

Dimensions



Performance Curves

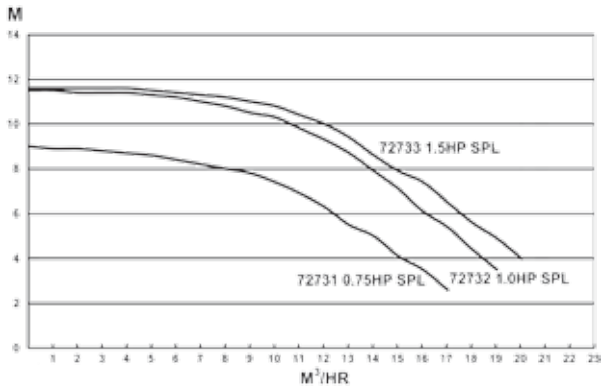

Optional connectors

Application

- Aboveground pools of all types and sizes (including inflatable pools, in-floor cleaning systems, solar heating systems, water features)

Features

- Easy thread design makes strainer cover removal easy
- See-thru strainer cover for you quick check when basket needs cleaning.
- Special PVC connector for quick connect and less time using. As following picture shows "optional connectors"
- All components molded of corrosion-proof reinforced thermoplastic for extra durability and long life
- Service-ease designed drain plug for easy maintenance in winter
- Using of the mechanical seals to lengthen the life and lower the noise
- Double insulation designed. The length of the cord is 7.6m



Model Number	H.P.	Voltage	Hertz	Amps	Flow Rate	Pipe Size	Dimension "L"	Carton Dimension (cm)
72731	0.75 SPL	115	60	7.3	62GPM	1 1/2"	359(14.1")	63*22*34
72732	1.0 SPL	115	60	9.2	75GPM	1 1/2"	366(14.4")	64*22*34
72733	1.5 SPL	115	60	12	83GPM	1 1/2"	372(14.6")	64*22*34
72735 two speed	1.0/0.41 SPL	115	60	10/3.2	75/36GPM	1 1/2"	366(14.4")	64*22*34
72736 two speed	1.5/0.46 SPL	115	60	12/3.6	83/40GPM	1 1/2"	372(14.6")	64*22*34